



# COE-013-C-POE-030-IR-C

Area Scan camera PYTHON 1300, CMOS, Global shutter, 1280 x 1024, 1.3 MP, 4.8 pix, 1/2", Color, 90 fps, GigE, POE, C - mount, Infrared cut filter

## SPECIFICATIONS

### Sensor Specifications

Sensor size	1/2"
Resolution	(pixel) 1280 x 1024
Pixel size	( $\mu\text{m}$ ) 4.8

### Camera Specifications

Color	Color
Frame rate	(Hz) 90
Compliance	GigE Vision, GenICam
Data format	Mono8/10/12, Bayer RG 8/10/10p/12/12p, YUV422Packed, YUV422_YUYV_Packed, RGB8
Dynamic range	Db >60dB
Gain range	Db 0-15dB
Snr	Db >40dB
Exposure time	s 62 $\mu\text{s}$ -10sec
IP	n.a.
Operating system	Windows XP/7/10 32/64bits

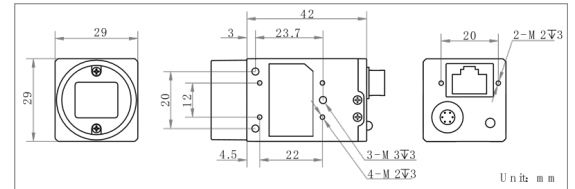

### Sensor details

Shutter type	Global shutter. Auto-Exposure, Manual Exposure
Sensor name	PYTHON 1300
Sensor type	CMOS

### Electrical specifications

Interface	Gigabit Ethernet
Image buffer	128 MB
I/O interface	Opto-isolated input x1, Opto-isolated output x1, Bi-directional non-isolated I/O x1
Power	Approx. 2.6W@12VDC Voltage 5~15VDC PoE supported
Operating temperature	$^{\circ}\text{C}$ 0 to 50
Operating humidity	%RH 20 to 80
Storage temperature	$^{\circ}\text{C}$ -30 to 70

### Mechanical specifications

Dimensions	(mm) 29 x 29 x 42
Model type	1
Mass	(g) Approx. 68
Lens Mount	C

### Compatible products

Compatibility	TC, TCCR, TCSM, TCLWD, TCCX, TCCXQ, TCZRS, TCBENCH, TCCRBENCH, TCEDGEVIS, PC, PCCD, PCHI, PCBP, PCPW, PCMP, TCCAGE, MC, MC3-03X, MCSM, MCZR, MZMT12X, ENMT, ENMP, ENHR, ENVF
---------------	--

Cable

CBETH003  
COE-6P-OPEN1-005, COE-6P-OPEN1-030, COE-6P-OPEN1-050,  
COE-6P-OPEN1-100, COE-6P-OPEN1-150, COE-6P-OPEN1-300

COMPATIBLE PRODUCTS



EN2MP series

Megapixel fixed focal lenses for 2/3" sensors

---

<a href="#">EN2MP0814</a>	Fixed focal 2 Megapixel lens, focal length 8 mm, f# 1.4 - C, C-mount
<a href="#">EN2MP1214</a>	Fixed focal 2 Megapixel lens, focal length 12 mm, f# 1.4 - C, C-mount
<a href="#">EN2MP1614</a>	Fixed focal 2 Megapixel lens, focal length 16 mm, f# 1.4 - 22, C-mount
<a href="#">EN2MP2514</a>	Fixed focal 2 Megapixel lens, focal length 25 mm, f# 1.4 - C, C-mount
<a href="#">EN2MP3514</a>	Fixed focal 2 Megapixel lens, focal length 35 mm, f# 1.4 - C, C-mount
<a href="#">EN2MP5018</a>	Fixed focal 2 Megapixel lens, focal length 50 mm, f# 1.8 - C, C-mount
<a href="#">EN2MP7528</a>	Fixed focal 2 Megapixel lens, focal length 75 mm, f# 2.8 - C, C-mount



EN5MP series

5 Megapixel high resolution fixed focal lenses for 2/3" sensors

---

<a href="#">EN5MP0816</a>	Fixed focal 5 Megapixel lens, focal length 8 mm, f# 1.6 - 22, C-mount
<a href="#">EN5MP1216</a>	Fixed focal 5 Megapixel lens, focal length 12 mm, f# 1.6 - 22, C-mount
<a href="#">EN5MP1616</a>	Fixed focal 5 Megapixel lens, focal length 16 mm, f# 1.6 - 22, C-mount
<a href="#">EN5MP2514</a>	Fixed focal 5 Megapixel lens, focal length 25 mm, f# 1.4 - 22, C-mount
<a href="#">EN5MP3514</a>	Fixed focal 5 Megapixel lens, focal length 35 mm, f# 1.4 - 22, C-mount
<a href="#">EN5MP5018</a>	Fixed focal 5 Megapixel lens, focal length 50 mm, f# 1.8 - 22, C-mount
<a href="#">EN5MP7520</a>	Fixed focal 5 Megapixel lens, focal length 75 mm, f# 2.0 - 22, C-mount