



# COE-003-C-POE-020-IR-C

Area Scan camera RJ33B4AD0DT, CCD, Global shutter, 640 x 480, 0.3 MP, 7.4 pix, 1/3", Color, 200 fps, GigE, POE, C - mount, Infrared cut filter

## SPECIFICATIONS

### Sensor Specifications

Sensor size	1/3"
Resolution (pixel)	640 x 480
Pixel size (µm)	7.4

### Camera Specifications

Color	Color
Frame rate (Hz)	200
Compliance	GigE Vision, GenICam
Data format	Mono 8/10/12, RGB8, Bayer GB 8/10/10p/12/12p, YUV 422 Packed, YUV422_YUYV_Packed
Dynamic range Db	>52dB
Gain range Db	0-20dB
Snr Db	>37dB
Exposure time s	20µs-1sec
IP	n.a.
Operating system	Windows XP/7/10 32/64bits

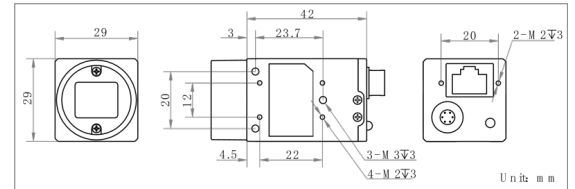

### Sensor details

Shutter type	Global shutter. Auto-Exposure, Manual Exposure
Sensor name	RJ33B4AD0DT
Sensor type	CCD

### Electrical specifications

Interface	Gigabit Ethernet
Image buffer	128 MB
I/O interface	Opto-isolated input x1, Opto-isolated output x1, Bi-directional non-isolated I/O x1
Power	Approx. 3.6W@12VDC Voltage 5~15VDC PoE supported
Operating temperature °C	0 to 50
Operating humidity %RH	20 to 80
Storage temperature °C	-30 to 70

### Mechanical specifications

Dimensions (mm)	29 x 29 x 42
Model type	1
Mass (g)	Approx. 68
Lens Mount	C

### Compatible products

Compatibility	TC, TCCR, TCSM, TCLWD, TCCX, TCCXQ, TCZRS, TCBENCH, TCCRBENCH, TCEDGEVIS, PC, PCCD, PCHI, PCPW, PCBP, MC, MC3-03X, MCSM, MCZR, MZMT12X, ENMT, ENMP, ENHR, ENVF
---------------	--



Cable

CBETH003  
COE-6P-OPEN1-005, COE-6P-OPEN1-030, COE-6P-OPEN1-050,  
COE-6P-OPEN1-100, COE-6P-OPEN1-150, COE-6P-OPEN1-300

COMPATIBLE PRODUCTS



EN2MP series

Megapixel fixed focal lenses for 2/3" sensors

---

<a href="#">EN2MP0814</a>	Fixed focal 2 Megapixel lens, focal length 8 mm, f# 1.4 - C, C-mount
<a href="#">EN2MP1214</a>	Fixed focal 2 Megapixel lens, focal length 12 mm, f# 1.4 - C, C-mount
<a href="#">EN2MP1614</a>	Fixed focal 2 Megapixel lens, focal length 16 mm, f# 1.4 - 22, C-mount
<a href="#">EN2MP2514</a>	Fixed focal 2 Megapixel lens, focal length 25 mm, f# 1.4 - C, C-mount
<a href="#">EN2MP3514</a>	Fixed focal 2 Megapixel lens, focal length 35 mm, f# 1.4 - C, C-mount
<a href="#">EN2MP5018</a>	Fixed focal 2 Megapixel lens, focal length 50 mm, f# 1.8 - C, C-mount
<a href="#">EN2MP7528</a>	Fixed focal 2 Megapixel lens, focal length 75 mm, f# 2.8 - C, C-mount



EN5MP series

5 Megapixel high resolution fixed focal lenses for 2/3" sensors

---

<a href="#">EN5MP0816</a>	Fixed focal 5 Megapixel lens, focal length 8 mm, f# 1.6 - 22, C-mount
<a href="#">EN5MP1216</a>	Fixed focal 5 Megapixel lens, focal length 12 mm, f# 1.6 - 22, C-mount
<a href="#">EN5MP1616</a>	Fixed focal 5 Megapixel lens, focal length 16 mm, f# 1.6 - 22, C-mount
<a href="#">EN5MP2514</a>	Fixed focal 5 Megapixel lens, focal length 25 mm, f# 1.4 - 22, C-mount
<a href="#">EN5MP3514</a>	Fixed focal 5 Megapixel lens, focal length 35 mm, f# 1.4 - 22, C-mount
<a href="#">EN5MP5018</a>	Fixed focal 5 Megapixel lens, focal length 50 mm, f# 1.8 - 22, C-mount
<a href="#">EN5MP7520</a>	Fixed focal 5 Megapixel lens, focal length 75 mm, f# 2.0 - 22, C-mount