



# COE-003-M-POE-010-IR-C

Bereichsabtastende-Kamera Python 300, CMOS, Global Shutter, 640 x 480, 0,3 MP, 4,8 Pixel, 1/4", Grau, GigE, POE, 173 fps, C-Mount, Glasfilter

ZUSATZANGABEN

Kamera-Vorschau GIGE\_29x29x42

Sensor Angaben

Sensor size	1/4"
Resolution	(pixel) 640 x 480
Pixel size	(µm) 4.8

Camera Angaben

Color	Mono
Frame rate	(Hz) 173
Compliance	GigE Vision, GenICam
Data format	Mono 8/10/10p/12/12p
Dynamic range	Db >60dB
Gain range	Db 0-9,5dB
Snr	Db >40dB
Exposure time	s 42µs-10sec
IP	n.a.
Operating system	Windows XP/7/10 32/64bits

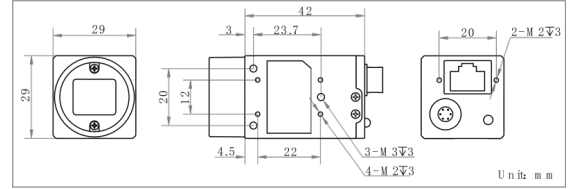

Sensor details

Shutter type	Global shutter. Auto-Exposure, Manual Exposure
Sensor name	Python 300
Sensor type	CMOS

Elektrische Angaben

Interface	Gigabit Ethernet
Image buffer	128 MB
I/O interface	Opto-isolated input x1, Opto-isolated output x1, Bi-directional non-isolated I/O x1
Power	< 3.0W@12VDC Voltage 5-15VDC PoE supported
Betriebstemperatur	°C 0 to 50
Operating humidity	%RH 20 to 80
Lagerungstemperatur	°C -30 to 70

Mechanische Angaben

Dimensionen	(mm) 29 x 29 x 42
Model type	1
Gewicht	(g) < 68
Lens Mount	C

Kompatible Produkte

Kompatibilität	TC, TCCR, TCSM, TCLWD, TCCX, TCCXQ, TCZRS, TCBENCH, TCCRBNCH, TCEDGEVIS, MC, MC3-03X, MCSM, MCZR, MZMT12X, ENMT, ENMP, ENHR, ENVF
Kabel	CBETH003 COE-6P-OPEN1-005, COE-6P-OPEN1-030, COE-6P-OPEN1-050, COE-6P-OPEN1-100, COE-6P-OPEN1-150, COE-6P-OPEN1-300

KOMPATIBLE PRODUKTE