



COE-012-C-POE-020-IR-C

Area Scan camera RJ33J4CA3DE, CCD, Global shutter, 1280 x 960, 1.2 MP, 3.75 pix, 1/3", Color, 30 fps, GigE, POE, C - mount, Infrared cut filter

SPECIFICATIONS

Sensor Specifications

Sensor size	1/3"
Resolution	(pixel) 1280 x 960
Pixel size	(μm) 3.75

Camera Specifications

Color	Color
Frame rate	(Hz) 30
Compliance	GigE Vision, GenICam
Data format	Mono 8/10/12, Bayer GR 8/10/10p/12/12p, YUV 422 Packed, YUV422_YUYV_Packed, RGB8
Dynamic range	Db >60dB
Gain range	Db 0-20dB
Snr	Db >37dB
Exposure time	s 34 μs -1sec
IP	n.a.
Operating system	Windows XP/7/10 32/64bits

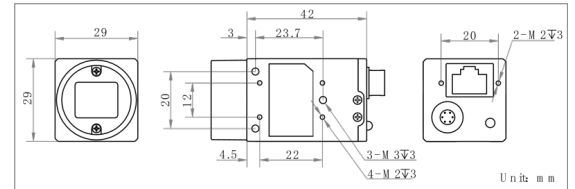

Sensor details

Shutter type	Global shutter. Auto-Exposure, Manual Exposure
Sensor name	RJ33J4CA3DE
Sensor type	CCD

Electrical specifications

Interface	Gigabit Ethernet
Image buffer	128 MB
I/O interface	Opto-isolated input x1, Opto-isolated output x1, Bi-directional non-isolated I/O x1
Power	Approx. 2.6W@12VDC Voltage 5~15VDC PoE supported
Operating temperature	$^{\circ}\text{C}$ 0 to 50
Operating humidity	%RH 20 to 80
Storage temperature	$^{\circ}\text{C}$ -30 to 70

Mechanical specifications

Dimensions	(mm) 29 x 29 x 42
Model type	1
Mass	(g) Approx. 68
Lens Mount	C

Compatible products

Compatibility	TC, TCCR, TCSM, TCLWD, TCCX, TCCXQ, TCZRS, TCBENCH, TCCRBENCH, TCEDGEVIS, PC, PCCD, PCHI, PCPW, PCBP, MC, MC3-03X, MCSM, MCZR, MZMT12X, ENMT, ENMP, ENHR, ENVF
---------------	--



Cable

CBETH003
COE-6P-OPEN1-005, COE-6P-OPEN1-030, COE-6P-OPEN1-050,
COE-6P-OPEN1-100, COE-6P-OPEN1-150, COE-6P-OPEN1-300

COMPATIBLE PRODUCTS



EN2MP series

Megapixel fixed focal lenses for 2/3" sensors

EN2MP0814	Fixed focal 2 Megapixel lens, focal length 8 mm, f# 1.4 - C, C-mount
EN2MP1214	Fixed focal 2 Megapixel lens, focal length 12 mm, f# 1.4 - C, C-mount
EN2MP1614	Fixed focal 2 Megapixel lens, focal length 16 mm, f# 1.4 - 22, C-mount
EN2MP2514	Fixed focal 2 Megapixel lens, focal length 25 mm, f# 1.4 - C, C-mount
EN2MP3514	Fixed focal 2 Megapixel lens, focal length 35 mm, f# 1.4 - C, C-mount
EN2MP5018	Fixed focal 2 Megapixel lens, focal length 50 mm, f# 1.8 - C, C-mount
EN2MP7528	Fixed focal 2 Megapixel lens, focal length 75 mm, f# 2.8 - C, C-mount



EN5MP series

5 Megapixel high resolution fixed focal lenses for 2/3" sensors

EN5MP0816	Fixed focal 5 Megapixel lens, focal length 8 mm, f# 1.6 - 22, C-mount
EN5MP1216	Fixed focal 5 Megapixel lens, focal length 12 mm, f# 1.6 - 22, C-mount
EN5MP1616	Fixed focal 5 Megapixel lens, focal length 16 mm, f# 1.6 - 22, C-mount
EN5MP2514	Fixed focal 5 Megapixel lens, focal length 25 mm, f# 1.4 - 22, C-mount
EN5MP3514	Fixed focal 5 Megapixel lens, focal length 35 mm, f# 1.4 - 22, C-mount
EN5MP5018	Fixed focal 5 Megapixel lens, focal length 50 mm, f# 1.8 - 22, C-mount
EN5MP7520	Fixed focal 5 Megapixel lens, focal length 75 mm, f# 2.0 - 22, C-mount