



COE-004-C-POE-010-IR-C

Area Scan camera Python 300, CMOS, Global shutter, 640 x 480, 0.3 MP, 4.8 pix, 1/4", Color, 300 fps, GigE, POE, C - mount, Infrared cut filter

SPECIFICATIONS

Sensor Specifications

Sensor size	1/4"
Resolution (pixel)	640 x 480
Pixel size (µm)	4.8

Camera Specifications

Color	Color
Frame rate (Hz)	300
Compliance	GigE Vision, GenICam
Data format	Mono8/10/12, Bayer RG 8/10/10p/12/12p YUV422Packed, YUV422_YUYV_Packed, RGB8
Dynamic range (Db)	>60dB
Gain range (Db)	0-15dB
Snr (Db)	>40dB
Exposure time (s)	40µs-10sec
IP	n.a.
Operating system	Windows XP/7/10 32/64bits

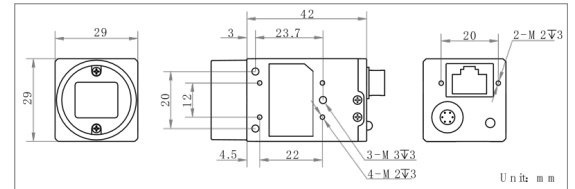

Sensor details

Shutter type	Global shutter. Auto-Exposure, Manual Exposure
Sensor name	Python 300
Sensor type	CMOS

Electrical specifications

Interface	Gigabit Ethernet
Image buffer	128 MB
I/O interface	Opto-isolated input x1, Opto-isolated output x1, Bi-directional non-isolated I/O x1
Power	< 3.0W@12VDC Voltage 5-15VDC PoE supported
Operating temperature (°C)	0 to 50
Operating humidity (%RH)	20 to 80
Storage temperature (°C)	-30 to 70

Mechanical specifications

Dimensions (mm)	29 x 29 x 42
Model type	1
Mass (g)	Approx. 68
Lens Mount	C

Compatible products

Compatibility	TC, TCCR, TCSM, TCLWD, TCCX, TCCXQ, TCZRS, TCBENCH, TCCRBENCH, TCEDGEVIS, MC, MC3-03X, MCSM, MCZR, MZMT12X, ENMT, ENMP, ENHR, ENVF
Cable	CBETH003 COE-6P-OPEN1-005, COE-6P-OPEN1-030, COE-6P-OPEN1-050, COE-6P-OPEN1-100, COE-6P-OPEN1-150, COE-6P-OPEN1-300

