

### FE185C086HA-1

Applicable camera (model) 1 2/3 1/2 1/3 1/4 For Security

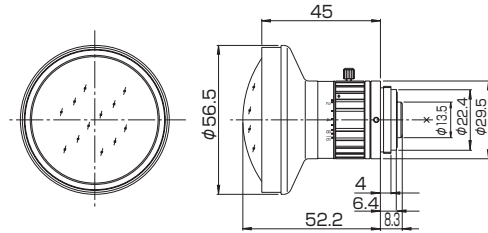

\* Photograph is a similar model.

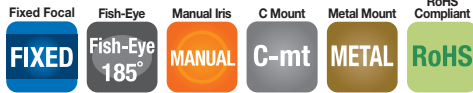

Unit : mm

FE185C086HA-1		
Focal Length (mm)		2.7
Iris Range		F1.8 - F16
Operation	Focus	Fixed
	Iris	Manual
Angle Of View (H×V)	1"	185° × 185°(φ8.6mm)
	2/3"	185° × 140°35'
	1/2"	136°18' × 102°19'
Focusing Range (From Front Of The Lens) (m)		∞ - 0.2
Back Focal Distance (in air) (mm)		9.75
Exit Pupil Position (From Image Plane) (mm)		-49
Filter Thread (mm)		-
Mount		C
Mass (g)		160
Remarks	<ul style="list-style-type: none"> <li>• With Metal Mount</li> <li>• With Locking Knob for Iris</li> </ul>	

#### [Fish-Eye Lens Image]



1"



2/3"



1/2"