

# COE-004-M-POE-010-IR-C

Area Scan camera Python 300, CMOS, Global shutter, 640 x 480, 0.3 MP, 4.8 pix, 1/4", Gray, 300 fps, GigE, POE, C - mount, Glass filter

## SPECIFICATIONS

### Sensor Specifications

Sensor size	1/4"
Resolution (pixel)	640 x 480
Pixel size (µm)	4.8

### Camera Specifications

Color	Mono
Frame rate (Hz)	300
Compliance	GigE Vision, GenICam
Data format	Mono 8/10/10p/12/12p
Dynamic range Db	>60dB
Gain range Db	0-15dB
Snr Db	>40dB
Exposure time s	49µs-10sec
IP	n.a.
Operating system	Windows XP/7/10 32/64bits

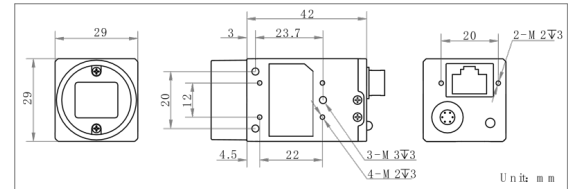

### Sensor details

Shutter type	Global shutter. Auto-Exposure, Manual Exposure
Sensor name	Python 300
Sensor type	CMOS

### Electrical specifications

Interface	Gigabit Ethernet
Image buffer	128 MB
I/O interface	Opto-isolated input x1, Opto-isolated output x1, Bi-directional non-isolated I/O x1
Power	< 3.0W@12VDC Voltage 5-15VDC PoE supported
Operating temperature °C	0 to 50
Operating humidity %RH	20 to 80
Storage temperature °C	-30 to 70

### Mechanical specifications

Dimensions (mm)	29 x 29 x 42
Model type	1
Mass (g)	Approx. 68
Lens Mount	C

### Compatible products

Compatibility	TC, TCCR, TCSM, TCLWD, TCCX, TCCXQ, TCZRS, TCBENCH, TCCRBENCH, TCEDGEVIS, MC, MC3-03X, MCSM, MCZR, MZMT12X, ENMT, ENMP, ENHR, ENVF
Cable	CBETH003 COE-6P-OPEN1-005, COE-6P-OPEN1-030, COE-6P-OPEN1-050, COE-6P-OPEN1-100, COE-6P-OPEN1-150, COE-6P-OPEN1-300



## COMPATIBLE PRODUCTS