



COE-013-M-POE-030-IR-C

Bereichsabtastende-Kamera PYTHON 1300, CMOS, Global Shutter, 1280 x 1024, 1,3 MP, 4,8 Pixel, 1/2", Grau, 90 fps, GigE, POE, C-Mount, Glasfilter

ZUSATZANGABEN

Sensor Angaben

Sensor size		1/2"
Resolution	(pixel)	1280 x 1024
Pixel size	(µm)	4.8

Camera Angaben

Color		Mono
Frame rate	(Hz)	90
Compliance		GigE Vision, GenICam
Data format		Mono 8/10/10p/12/12p
Dynamic range	Db	>60dB
Gain range	Db	0-15dB
Snr	Db	>40dB
Exposure time	s	38µs-10sec
IP		n.a.
Operating system		Windows XP/7/10 32/64bits

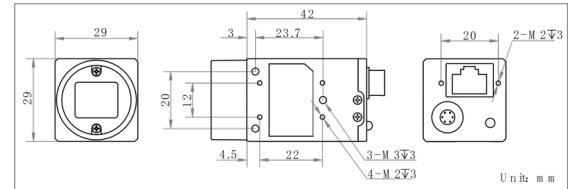

Sensor details

Shutter type		Global shutter. Auto-Exposure, Manual Exposure
Sensor name		PYTHON 1300
Sensor type		CMOS

Elektrische Angaben

Interface		Gigabit Ethernet
Image buffer		128 MB
I/O interface		Opto-isolated input x1, Opto-isolated output x1, Bi-directional non-isolated I/O x1
Power		Approx. 2.6W@12VDC Voltage 5-15VDC PoE supported
Betriebstemperatur	°C	0 to 50
Operating humidity	%RH	20 to 80
Lagerungstemperatur	°C	-30 to 70

Mechanische Angaben

Dimensionen	(mm)	29 x 29 x 42
Model type		1
Gewicht	(g)	Approx. 68
Lens Mount		C

Kompatible Produkte

Kompatibilität		TC, TCCR, TCSM, TCLWD, TCCX, TCCXQ, TCZRS, TCBENCH, TCCRBENCH, TCEDGEVIS, PC, PCCD, PCHI, PCBP, PCPW, PCMP, TCCAGE, MC, MC3-03X, MCSM, MCZR, MZMT12X, ENMT, ENMP, ENHR, ENVF
Kabel		CBETH003 COE-6P-OPEN1-005, COE-6P-OPEN1-030, COE-6P-OPEN1-050, COE-6P-OPEN1-100, COE-6P-OPEN1-150, COE-6P-OPEN1-300





EN2MP-Serie

Megapixel-Fixfokus-Objektive für 2/3"-Sensoren

EN2MP0814	Fixed focal 2 Megapixel lens, focal length 8 mm, f# 1.4 - C, C-mount
EN2MP1214	Fixed focal 2 Megapixel lens, focal length 12 mm, f# 1.4 - C, C-mount
EN2MP1614	Fixed focal 2 Megapixel lens, focal length 16 mm, f# 1.4 - 22, C-mount
EN2MP2514	Fixed focal 2 Megapixel lens, focal length 25 mm, f# 1.4 - C, C-mount
EN2MP3514	Fixed focal 2 Megapixel lens, focal length 35 mm, f# 1.4 - C, C-mount
EN2MP5018	Fixed focal 2 Megapixel lens, focal length 50 mm, f# 1.8 - C, C-mount
EN2MP7528	Fixed focal 2 Megapixel lens, focal length 75 mm, f# 2.8 - C, C-mount



EN5MP-Serie

Hochauflösende 5-Megapixel-Fixfokus-Objektive für 2/3"-Sensoren

EN5MP0816	Fixed focal 5 Megapixel lens, focal length 8 mm, f# 1.6 - 22, C-mount
EN5MP1216	Fixed focal 5 Megapixel lens, focal length 12 mm, f# 1.6 - 22, C-mount
EN5MP1616	Fixed focal 5 Megapixel lens, focal length 16 mm, f# 1.6 - 22, C-mount
EN5MP2514	Fixed focal 5 Megapixel lens, focal length 25 mm, f# 1.4 - 22, C-mount
EN5MP3514	Fixed focal 5 Megapixel lens, focal length 35 mm, f# 1.4 - 22, C-mount
EN5MP5018	Fixed focal 5 Megapixel lens, focal length 50 mm, f# 1.8 - 22, C-mount
EN5MP7520	Fixed focal 5 Megapixel lens, focal length 75 mm, f# 2.0 - 22, C-mount