

COE-050-M-POE-023-IR-C

Area Scan camera MT9P031, CMOS, Rolling shutter, 2592 x 1944, 5 MP, 2.2 pix, 1/2.5", Gray, 14 fps, GigE, POE, C - mount, Glass filter

SPECIFICATIONS

Sensor Specifications

Sensor size		1/2.5"
Resolution	(pixel)	2592 x 1944
Pixel size	(μm)	2.2

Camera Specifications

Color		Mono
Frame rate	(Hz)	14
Compliance		GigE Vision, GenICam
Data format		Mono 8/10/10p/12/12p
Dynamic range	Db	>60dB
Gain range	Db	0-20dB
Snr	Db	38dB
Exposure time	s	34 μs -1sec
IP		n.a.
Operating system		Windows XP/7/10 32/64bits

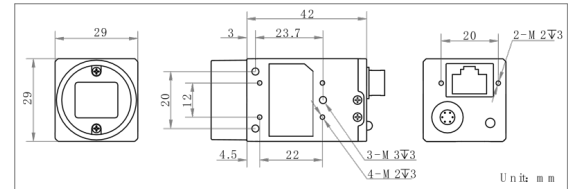

Sensor details

Shutter type		Rolling shutter. Auto-Exposure, Manual Exposure
Sensor name		MT9P031
Sensor type		CMOS

Electrical specifications

Interface		Gigabit Ethernet
Image buffer		128 MB
I/O interface		Opto-isolated input x1, Opto-isolated output x1, Bi-directional non-isolated I/O x1
Power		< 2.75W@12VDC Voltage 5-15VDC PoE supported
Operating temperature	$^{\circ}\text{C}$	0 to 50
Operating humidity	%RH	20 to 80
Storage temperature	$^{\circ}\text{C}$	-30 to 70

Mechanical specifications

Dimensions	(mm)	29 x 29 x 42
Model type		1
Mass	(g)	< 68
Lens Mount		C

Compatible products

Compatibility		TC, TCCR, TCSM, TCLWD, TCCX, TCCXQ, TCZRS, TCBENCH, TCCRBENCH, TCEDGEVIS, PC, PCCD, PCHI, PCPW, PCBP, MC, MC3-03X, MCSM, MCZR, MZMT12X, ENMT, ENMP, ENHR, ENVF
Cable		CBETH003 COE-6P-OPEN1-005, COE-6P-OPEN1-030, COE-6P-OPEN1-050, COE-6P-OPEN1-100, COE-6P-OPEN1-150, COE-6P-OPEN1-300



COMPATIBLE PRODUCTS



EN2MP series

Megapixel fixed focal lenses for 2/3" sensors

EN2MP0814	Fixed focal 2 Megapixel lens, focal length 8 mm, f# 1.4 - C, C-mount
EN2MP1214	Fixed focal 2 Megapixel lens, focal length 12 mm, f# 1.4 - C, C-mount
EN2MP1614	Fixed focal 2 Megapixel lens, focal length 16 mm, f# 1.4 - 22, C-mount
EN2MP2514	Fixed focal 2 Megapixel lens, focal length 25 mm, f# 1.4 - C, C-mount
EN2MP3514	Fixed focal 2 Megapixel lens, focal length 35 mm, f# 1.4 - C, C-mount
EN2MP5018	Fixed focal 2 Megapixel lens, focal length 50 mm, f# 1.8 - C, C-mount
EN2MP7528	Fixed focal 2 Megapixel lens, focal length 75 mm, f# 2.8 - C, C-mount



EN5MP series

5 Megapixel high resolution fixed focal lenses for 2/3" sensors

EN5MP0816	Fixed focal 5 Megapixel lens, focal length 8 mm, f# 1.6 - 22, C-mount
EN5MP1216	Fixed focal 5 Megapixel lens, focal length 12 mm, f# 1.6 - 22, C-mount
EN5MP1616	Fixed focal 5 Megapixel lens, focal length 16 mm, f# 1.6 - 22, C-mount
EN5MP2514	Fixed focal 5 Megapixel lens, focal length 25 mm, f# 1.4 - 22, C-mount
EN5MP3514	Fixed focal 5 Megapixel lens, focal length 35 mm, f# 1.4 - 22, C-mount
EN5MP5018	Fixed focal 5 Megapixel lens, focal length 50 mm, f# 1.8 - 22, C-mount
EN5MP7520	Fixed focal 5 Megapixel lens, focal length 75 mm, f# 2.0 - 22, C-mount