



COE-003-C-POE-010-IR-C

Area Scan camera Python 300, CMOS, Global shutter, 640 x 480, 0.3 MP, 4.8 pix, 1/4", Color, 173 fps, GigE, POE, C - mount, Infrared cut filter

SPECIFICATIONS

Sensor Specifications

Sensor size	1/4"
Resolution	(pixel) 640 x 480
Pixel size	(μm) 4.8

Camera Specifications

Color	Color
Frame rate	(Hz) 173
Compliance	GigE Vision, GenICam
Data format	Mono 8/10/12, RGB8, Bayer RG 8/10/10p/12/12p, YUV 422 Packed, YUV422_YUYV_Packed
Dynamic range	Db >60dB
Gain range	Db 0-9.5dB
Snr	Db >40dB
Exposure time	s 42 μs -10sec
IP	n.a.
Operating system	Windows XP/7/10 32/64bits

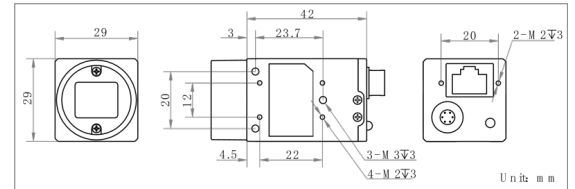

Sensor details

Shutter type	Global shutter. Auto-Exposure, Manual Exposure
Sensor name	Python 300
Sensor type	CMOS

Electrical specifications

Interface	Gigabit Ethernet
Image buffer	128 MB
I/O interface	Opto-isolated input x1, Opto-isolated output x1, Bi-directional non-isolated I/O x1
Power	< 3.0W@12VDC Voltage 5~15VDC PoE supported
Operating temperature	$^{\circ}\text{C}$ 0 to 50
Operating humidity	%RH 20 to 80
Storage temperature	$^{\circ}\text{C}$ -30 to 70

Mechanical specifications

Dimensions	(mm) 29 x 29 x 42
Model type	1
Mass	(g) < 68
Lens Mount	C

Compatible products

Compatibility	TC, TCCR, TCSM, TCLWD, TCCX, TCCXQ, TCZRS, TCBENCH, TCCRBENCH, TCEDGEVIS, MC, MC3-03X, MCSM, MCZR, MZMT12X, ENMT, ENMP, ENHR, ENVF
---------------	---

